

# THE EASIEST PERCLOSE EVER

PERCLOSE  
**PROGLIDE**  
SUTURE-MEDIATED CLOSURE SYSTEM

## 1 POSITIONING

- Advance the Perclose ProGlide straight into the artery coaxial to the tissue tract, keeping the device logo pointed towards the ceiling. Discontinue advancement as soon as arterial flow is seen through the marker lumen.
- While keeping the device at a 45° angle, lift the lever (marked #1) up to deploy the foot inside the artery.
- Gently retract the device at a 45° angle until marking has stopped.

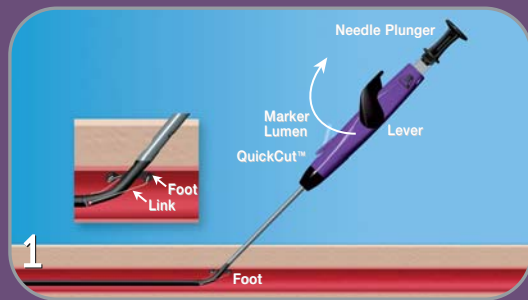

## 2 NEEDLE DEPLOYMENT

- While maintaining a 45° angle, fully depress the plunger (in the direction marked #2) until the collar touches the body of the device. This will deploy the needles and capture the suture.

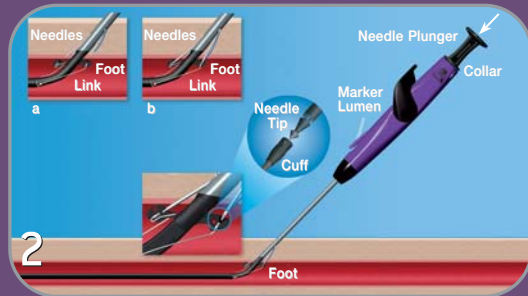

## 3 PLUNGER REMOVAL

- While stabilizing the device with your free hand, retrieve the suture by removing the plunger (in the direction marked #3) from the device.
- Retract the plunger until the suture is pulled taut. Only ONE blue rail suture is presented.
- Utilizing either the QuickCut™ mechanism (a) or sterile scissors (b), cut the plunger free by cutting the BLUE suture approximately 1 cm below the WHITE link.

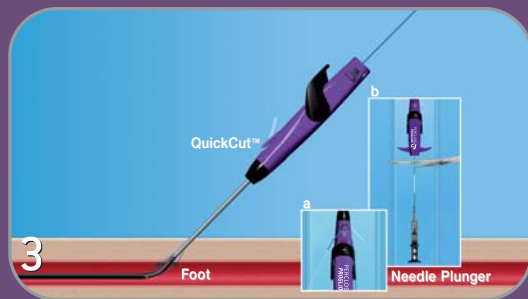

## 4 SUTURE HARVEST

- Relax the device and return the lever (marked #4) to its original position to park the foot.
- Deliberately withdraw the Perclose ProGlide until the guide wire exit port is at skin level. Remove the two suture ends from the device. There should be one BLUE suture (the RAIL suture – BLUE TAIL IS THE RAIL) and one WHITE suture (the NON-RAIL-WHITE MAKES IT TIGHT).

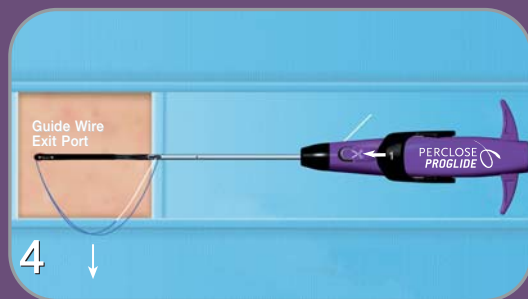

## 5 KNOT ADVANCEMENT/Test for Hemostasis

- Maintain constant back tension on the BLUE rail suture with your left hand, keeping the suture coaxial to the tissue tract. (This will begin to advance the knot toward the arteriotomy, and tent the artery causing hemostasis). Withdraw the Perclose ProGlide from the tissue tract and pick up the Suture Trimmer with your right hand.
- Load the BLUE rail suture into the Suture Trimmer and advance the knot forward to the arteriotomy.
- With the BLUE rail suture wrapped around your left forefinger, place the Suture Trimmer under your left thumb to assume a single-handed position and complete knot advancement. Tighten the knot gently pulling on the WHITE non-rail suture (WHITE MAKES IT TIGHT).
- Remove the Suture Trimmer from the tissue tract and test for hemostasis by having the patient cough or bend his/her leg.
- If hemostasis is achieved, continue to next step. If additional hemostasis is desired, assume single-handed position for 20 seconds.
- Hold constant back tension and load both suture limbs into the Suture Trimmer and advance to the arteriotomy. Trim the sutures by pulling back on the red Trimming Lever. Keep the red Trimming Lever pulled back during retrieval of the Suture Trimmer from the tissue tract.

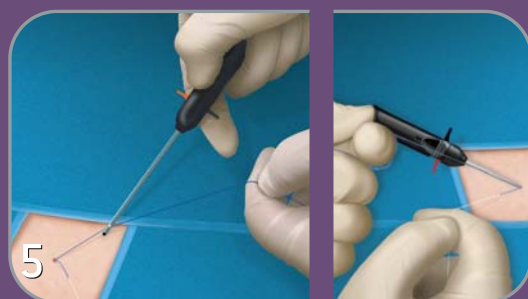

PERCLOSE ProGlide Suture-Mediated Closure System  
PRODUCT CODE: 12673

Each Perclose ProGlide System Includes:

- 1 Perclose ProGlide
- 1 Suture Trimmer
- 1 Snared Knot Pusher

10 SYSTEMS PER BOX

To place an order call: 800.222.6883

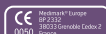

\*See I.F.U. for more procedural information

**AbbottVascular**  
DEVICES